



USER GUIDE



MALE RECTAL EXAMINATION TRAINER

ADVANCED

This product is available
in light and dark skin tones

60171

60187

FOR MORE SKILLS TRAINING PRODUCTS VISIT

limbsandthings.com

Sussex Street, St Philips, Bristol, BS2 0RA, UK | sales@limbsandthings.com | +44 (0) 117 311 0500

INDEX

PACKAGE SUPPLIED	3
SAFETY & CLEANING INSTRUCTIONS	4
SET UP	5
• SETTING UP THE EXAMINATION POSITION	5
• FITTING/CHANGING THE PERINEUM	6
• FITTING/CHANGING THE PROSTATE	8
• ADDING IMPACTED FAECAL MATTER	9
TRAINING	10
• PERFORMING THE DIGITAL RECTAL EXAMINATION	10
• ASSESSING ANAL TONE	10
CLEANING & STORAGE	11
• CLEANING & STORAGE AFTER USE	11

TAKE A LOOK
AT OUR **VIDEO**



VISIT THE WEBSITE
limbsandthings.com

OR YOUTUBE CHANNEL
youtube.com/limbsandthings

PACKAGE
SUPPLIED

Base Unit

60177

60191



External Conditions Illustration Pack

60173

60188



Left Lateral Stand

60174



Perineum - Normal

60175

60189

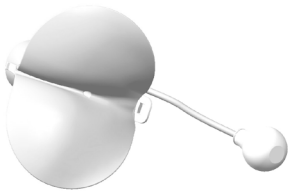

Perineum - Pathological

60176

60190

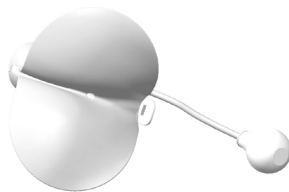

Water-Based Lubricant

00293



60178

Prostates & Faecal Matter Set

60179

Prostate - Normal



60180

Prostate - Benign Unilateral Enlarged



60181

Prostate - Benign Bilateral Enlarged

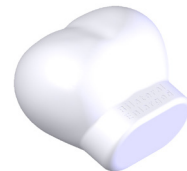

60182

Prostate Unilateral Carcinoma



60183

Prostate Bilateral Carcinoma



60184

Impacted Faecal Matter



SAFETY & CLEANING INSTRUCTIONS

READ THE SAFETY INSTRUCTIONS CAREFULLY BEFORE USING YOUR MALE RECTAL EXAMINATION TRAINER

DO's



Follow all instructions. Keep these instructions. Heed all warnings.

Only use water-based lubricant, such as the one supplied, with this model. Use of non-recommended products may weaken or damage the silicone.



Wear gloves at all times and remove all jewellery items. Sharp surfaces such as finger nails and rings can lead to damage of silicone parts.

Lubricate your examining finger before insertion.



Clean the product with a damp soft cloth or sponge, using only warm water with mild detergent, after every training session. Clean off excess lubricant, and remove any enemas, suppositories or creams as these can damage the product.

STORAGE & TRANSPORTATION



Always ensure that the products are properly packed and secured during transportation and storage in order to prevent personal injury or damage to the product. Take care to keep the perineums away from sharp or heavy objects that could cause a puncture.

DON'Ts



Do not install near any heat sources, do not expose the product to flames or use near naked flame sources. Do not use flammable solvents near or on this product.

Do not use any attachments other than those supplied by the manufacturer.



Do not wear any jewellery items. Do not insert anything other than your finger or rectal medications designed for human use into the rectum.

Do not use excessive force on the pulse bulb or anus and do not apply undue pressure or weight to the outer edges of the perineum.

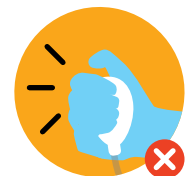

Do not use if the skin is torn.

Do not disassemble the product or attempt to repair a faulty unit, please return the product to Limbs & Things for assessment and repair.



Do not allow young children to use this product.

SET UP

SETTING UP THE EXAMINATION POSITION

Left Lateral Decubitus Position

Use the supplied **Left Lateral Stand (60174)**

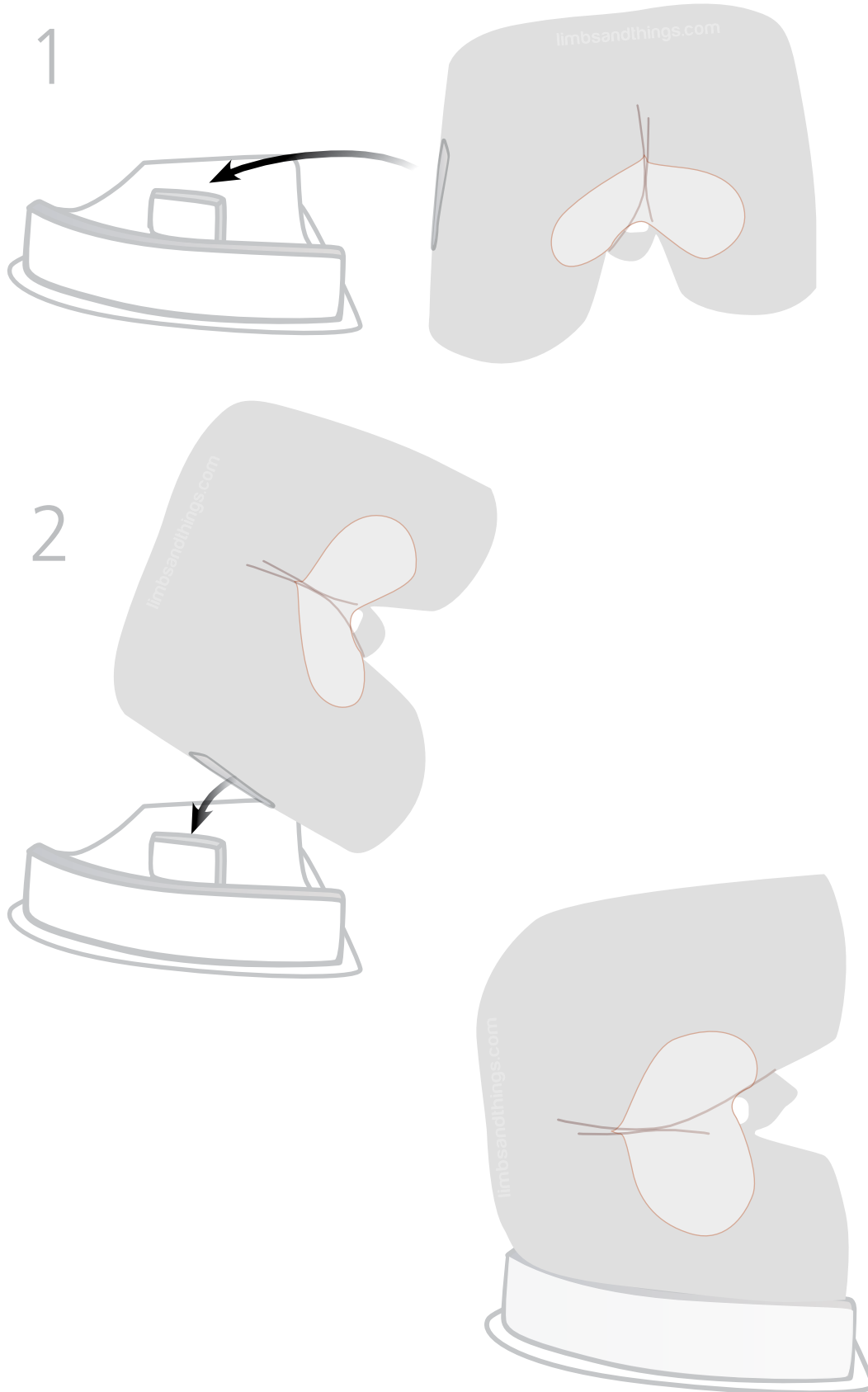

SET UP

FITTING/CHANGING THE PERINEUM

REMOVE

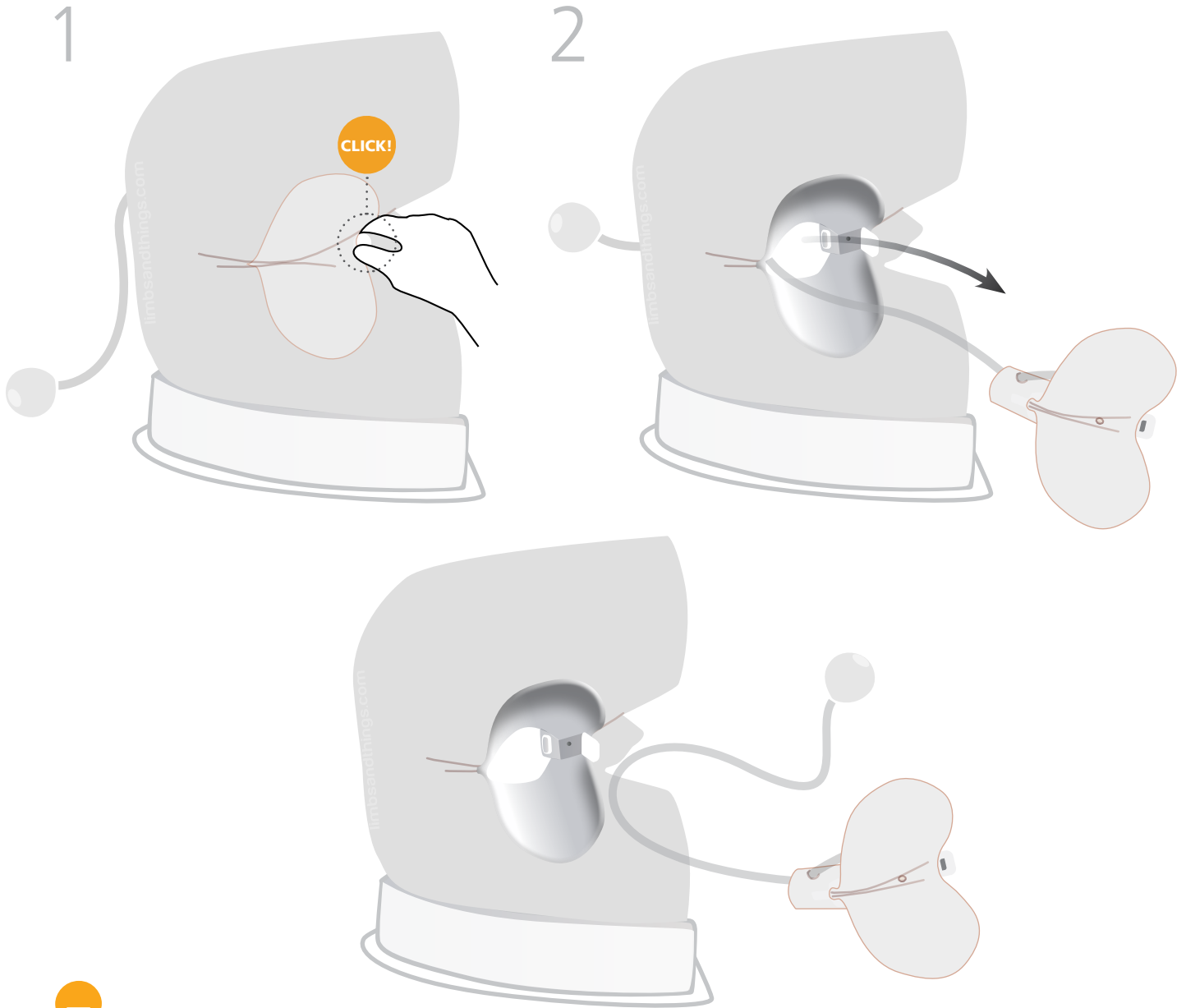

The **Pathological Perineum** can be identified by the cancer and polyp on the internal wall

NORMAL

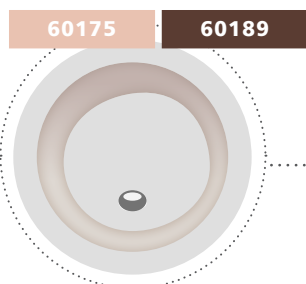

PATHOLOGICAL

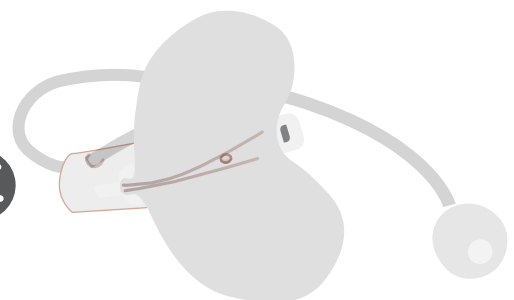
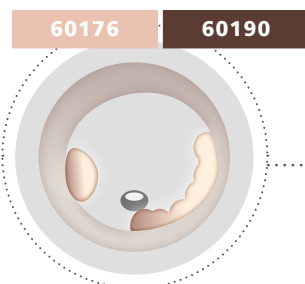

SET UP

ATTACH

1

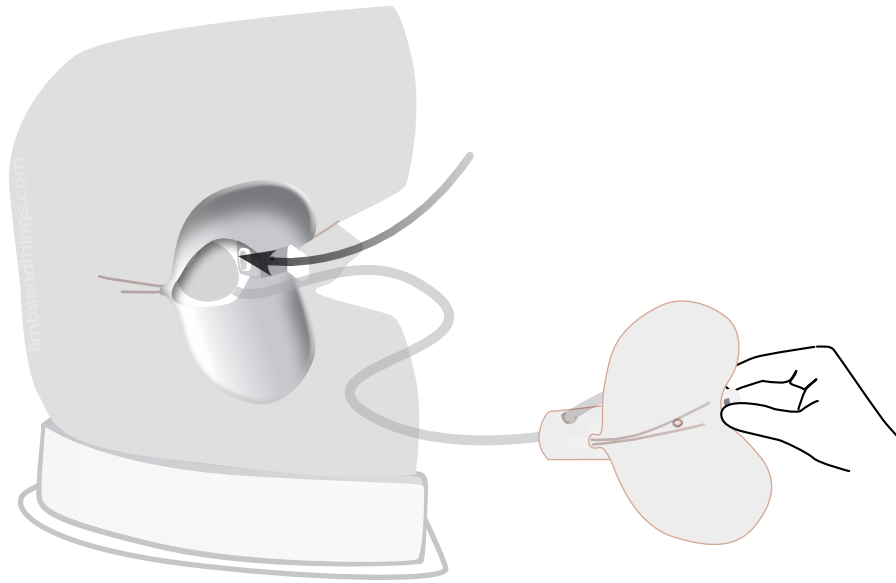

2

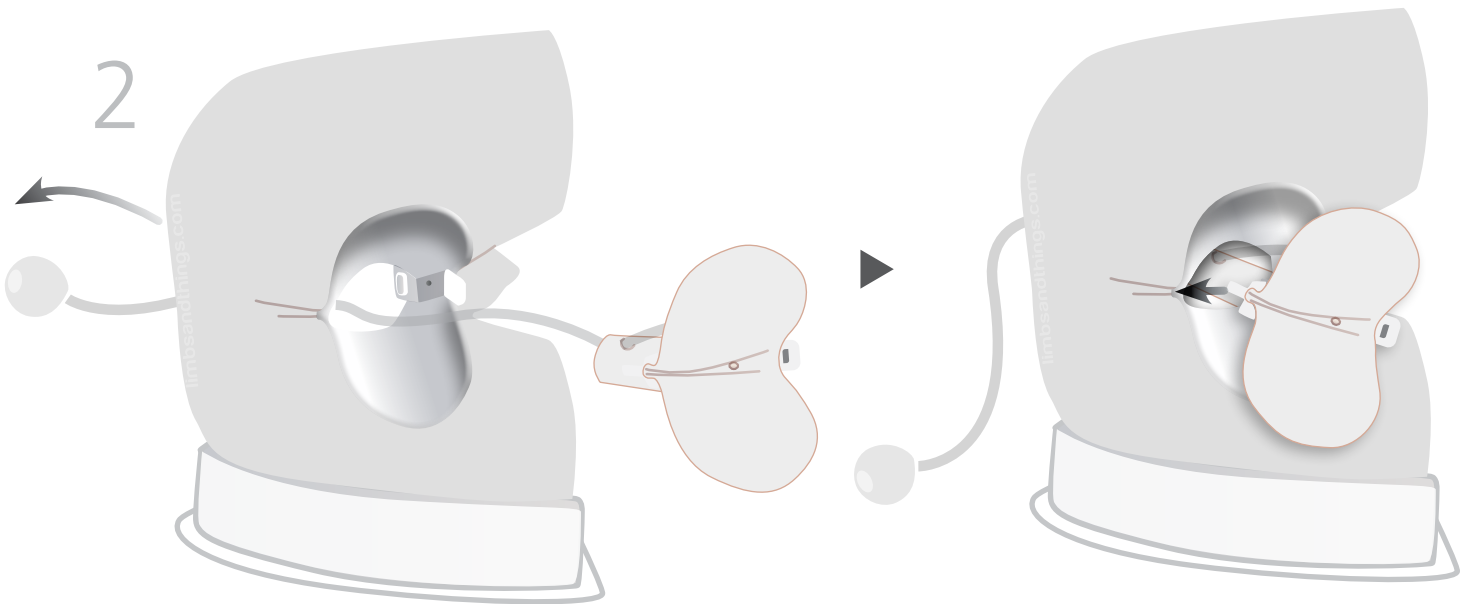

3

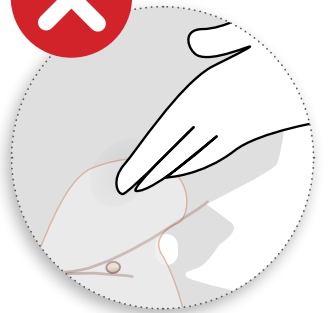
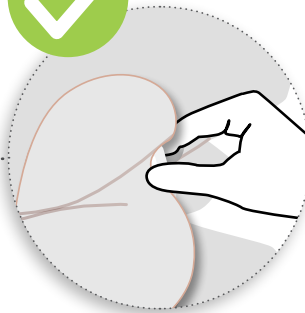
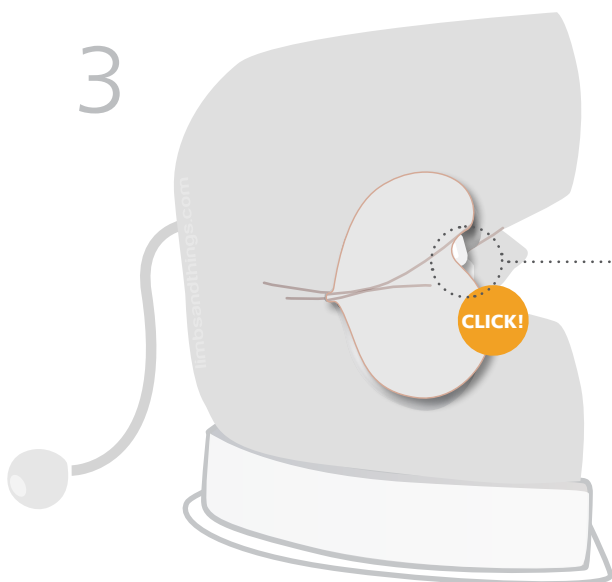

Always use the white tab to fit the perineum into place.



Do not press down on the outer edges of the perineum

SET UP

FITTING/CHANGING THE PROSTATE

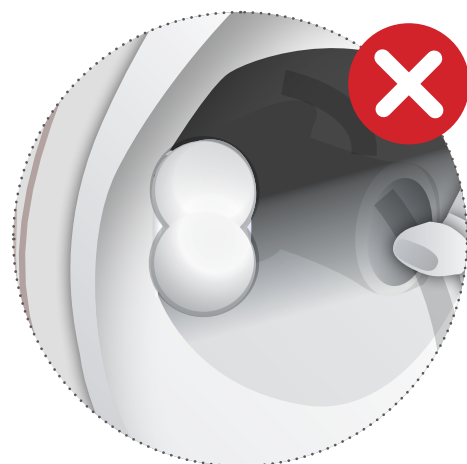
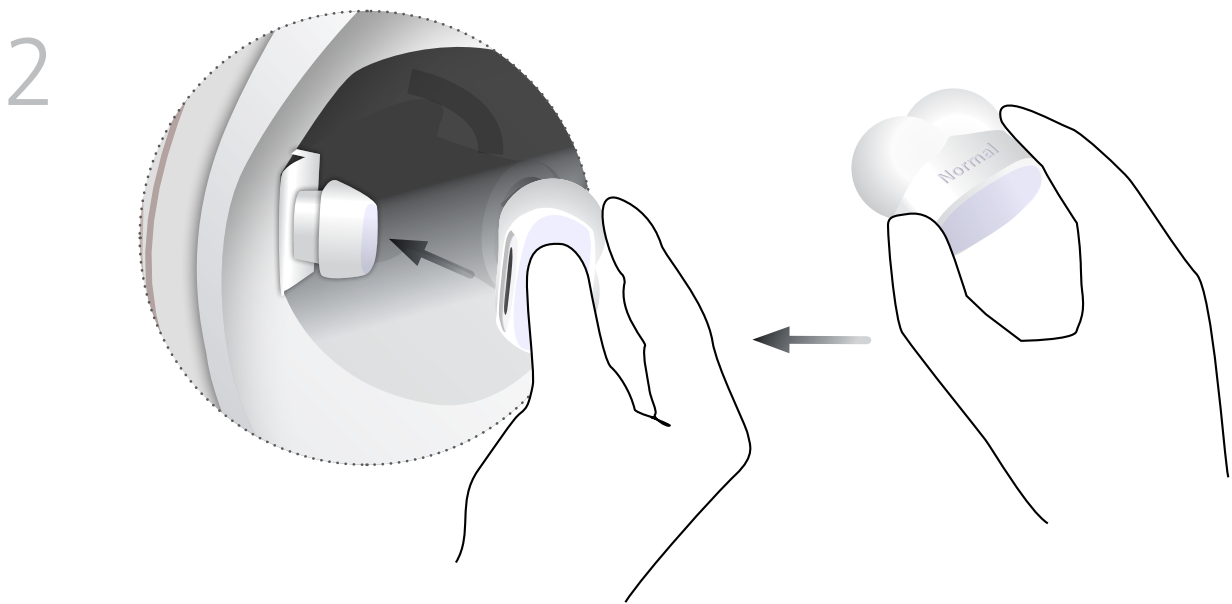
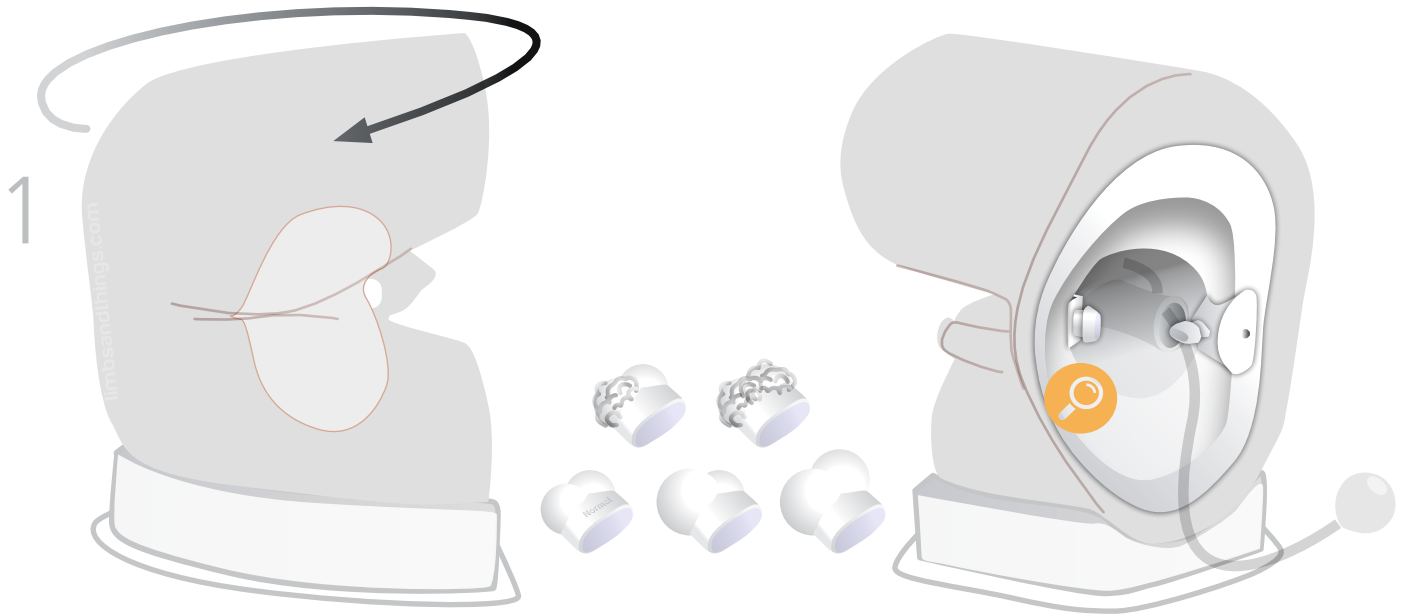

SET UP

ADDING IMPACTED FAECAL MATTER

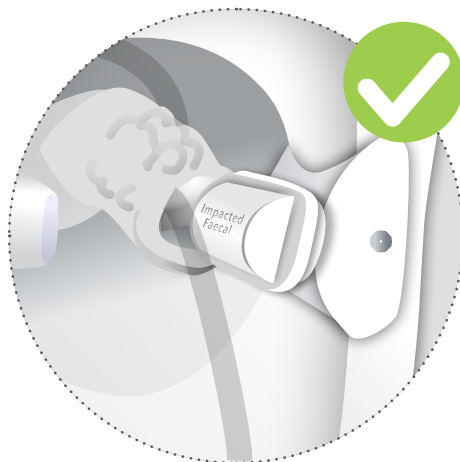
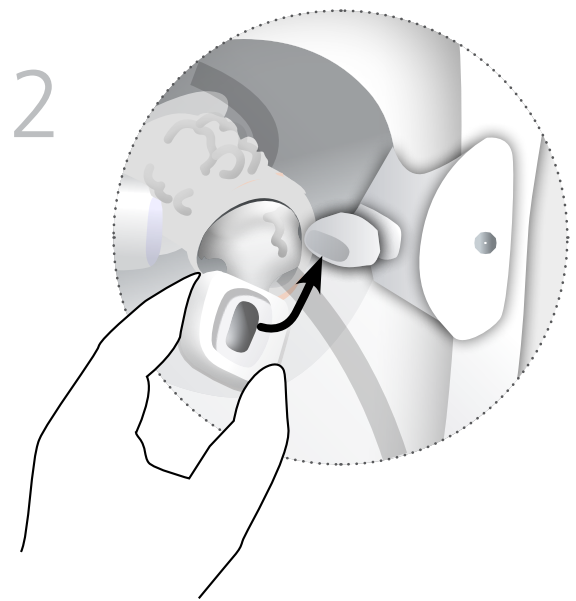
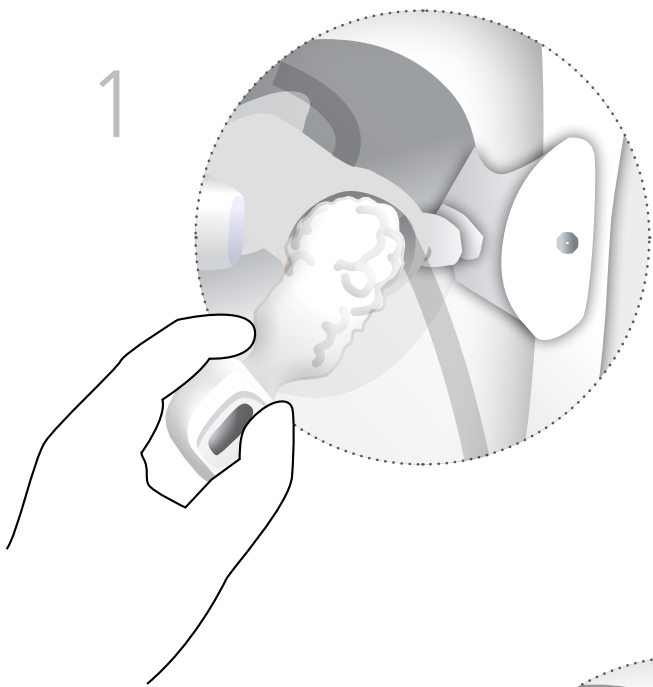
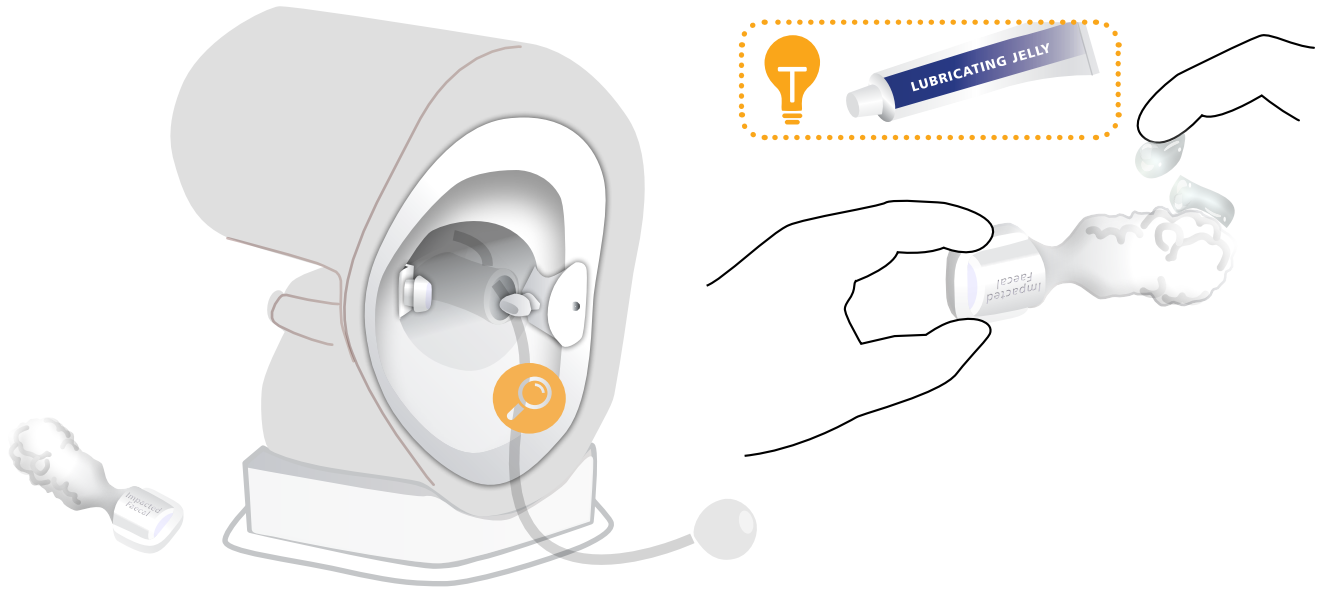

TRAINING

PERFORMING THE DIGITAL RECTAL EXAMINATION

- Wear gloves at all times and remove all jewellery items. Sharp surfaces such as finger nails and rings can lead to damage of silicone parts.
- Lubricate the examining finger prior to insertion into the rectum.

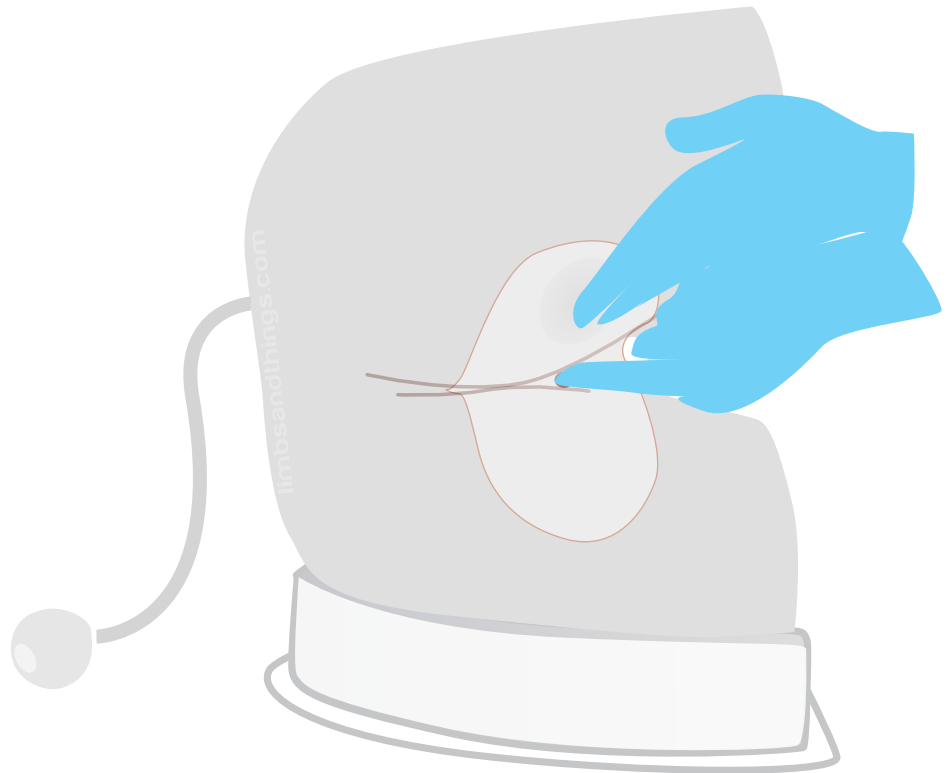

ASSESSING ANAL TONE

The person performing the examination will feel the grip on their examination finger.

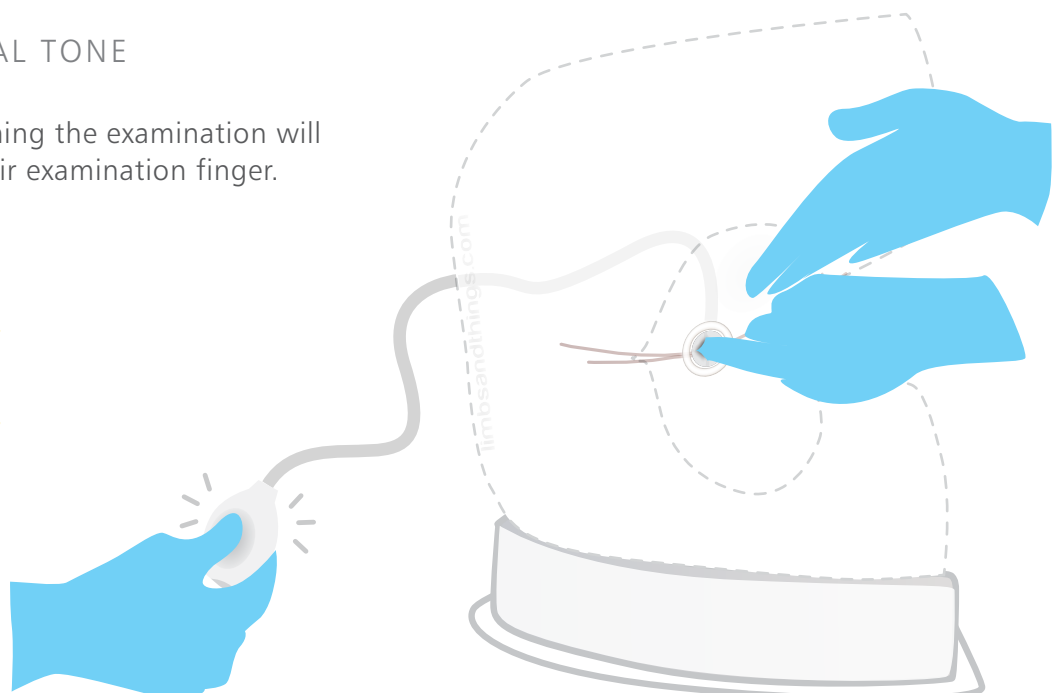

TRAINING

ASSESSING ANAL TONE

Squeeze the pulse bulb to simulate contraction of the sphincter and assess anal tone.

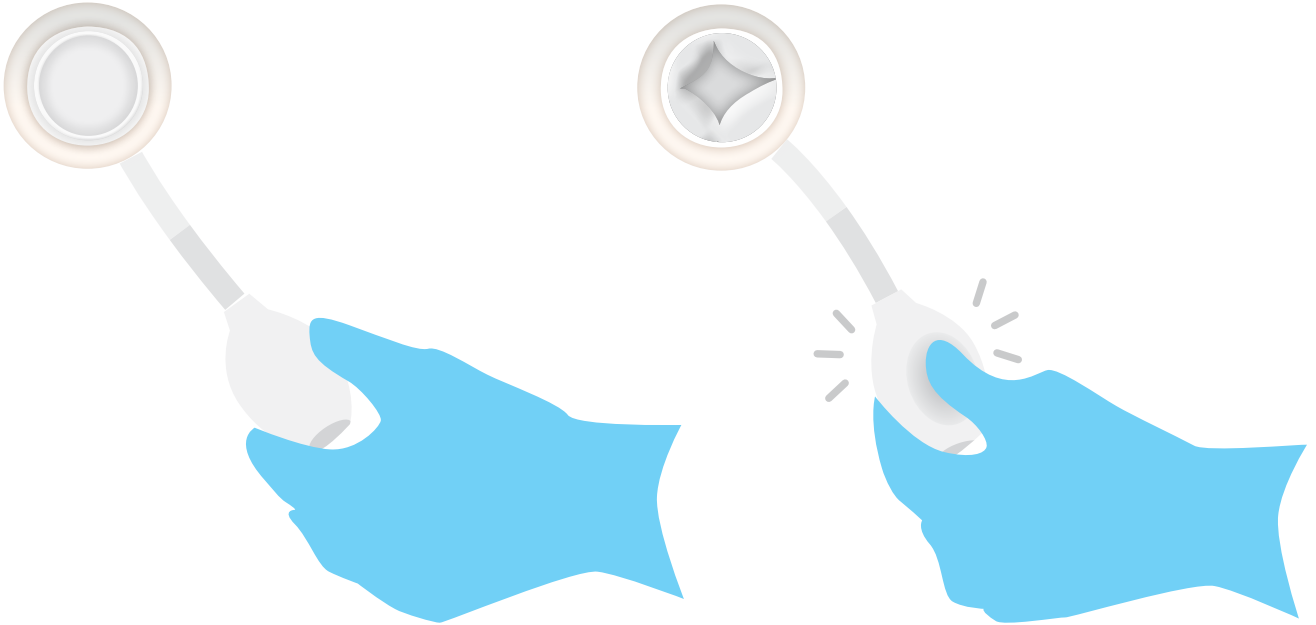

CLEANING AND STORAGE

- Wipe off excess lubricant with a soft cloth
- Clean off any surface dirt with a damp, soft cloth, using only warm water and mild detergent



YOU MAY
ALSO BE
INTERESTED IN...

60172

STANDING POSITION STAND

For examination in semi-standing position.

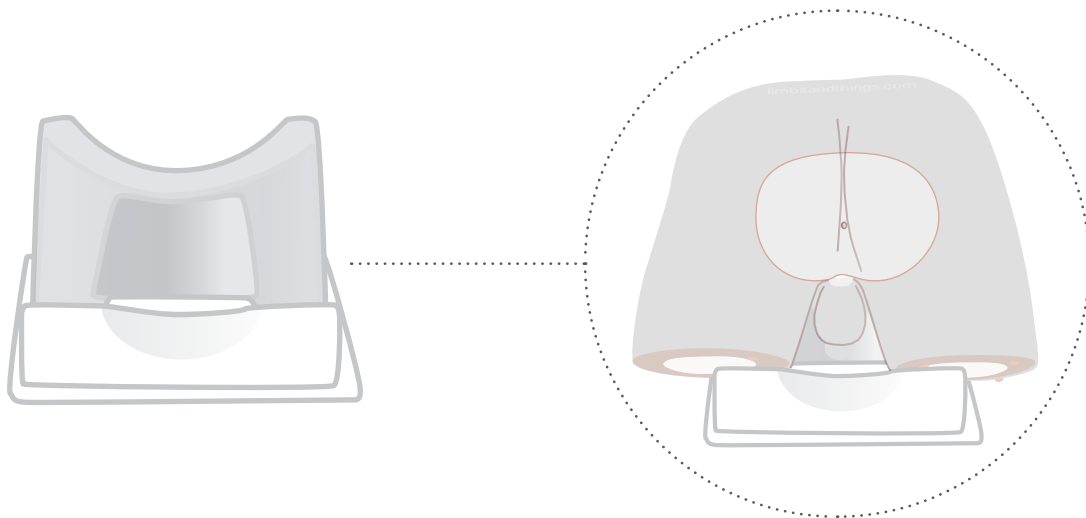

40209

MEDIUM CARRY CASE

